

# BIM Adoption

Thomas Gregersen  
Senior Technical Sales Specialist



The background of the slide is an abstract, artistic composition of thick, flowing, translucent blue and white lines. These lines swirl and curve across the frame, creating a sense of dynamic movement and depth. The lines vary in opacity, with some appearing as bright white highlights and others as deep, saturated blues. The overall effect is reminiscent of a complex, interconnected network or a fluid, organic structure.

# The BIM Challenge



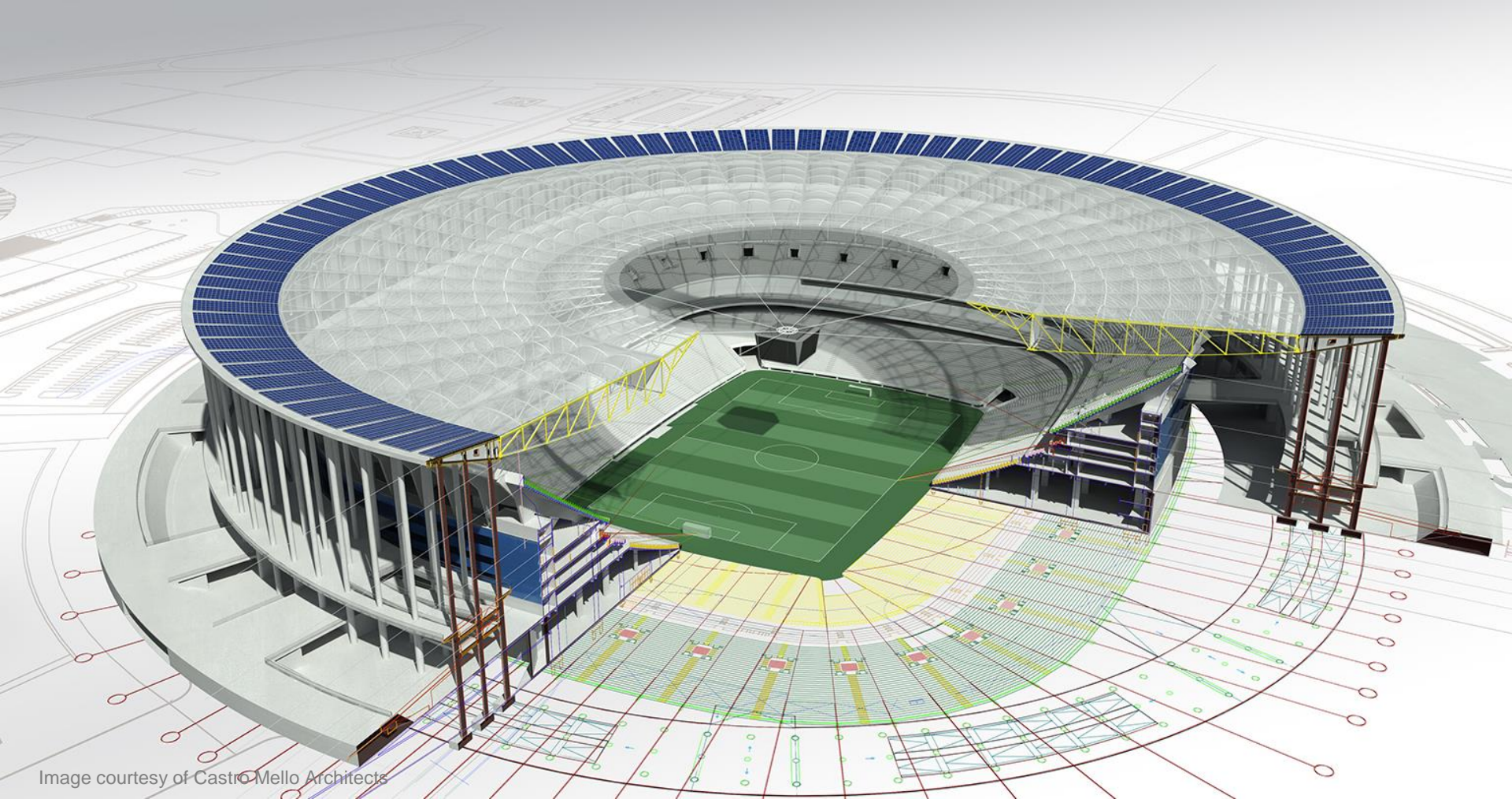
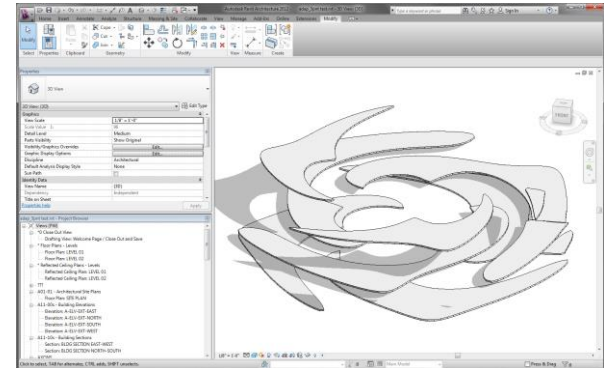
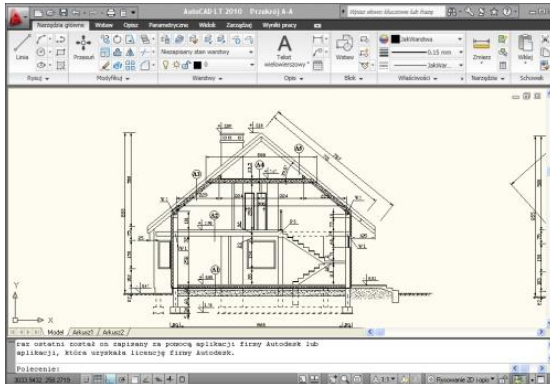
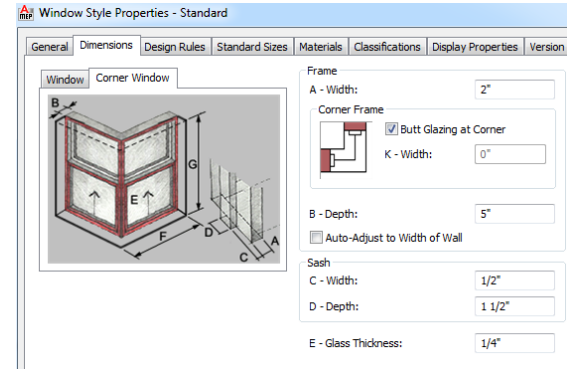

Image courtesy of Castro Mello Architects

# The Challenge



# Model Based Design – a Cultural Change

There's more to a project than just drafting

Design

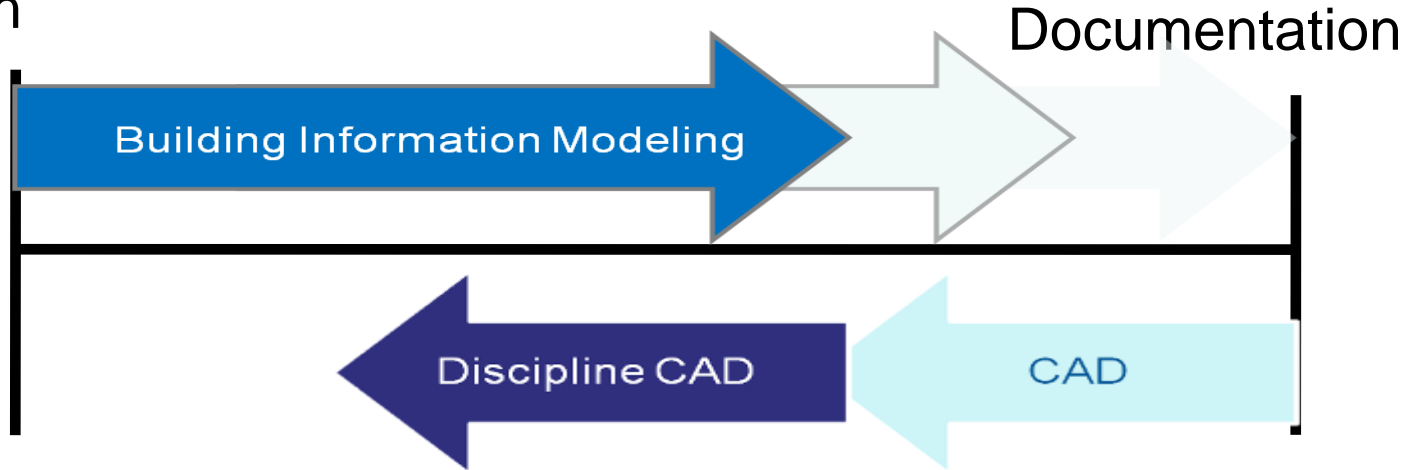

BIM is a holistic design approach that focuses on design support for visualization, simulation, analysis and collaboration



The background of the slide features a complex, abstract composition of overlapping, translucent blue and white geometric shapes. These shapes, which resemble stylized architectural forms or data structures, are rendered with soft lighting and shadows, creating a sense of depth and movement. The overall aesthetic is clean, modern, and technical.

**So what is BIM?**

# BIM

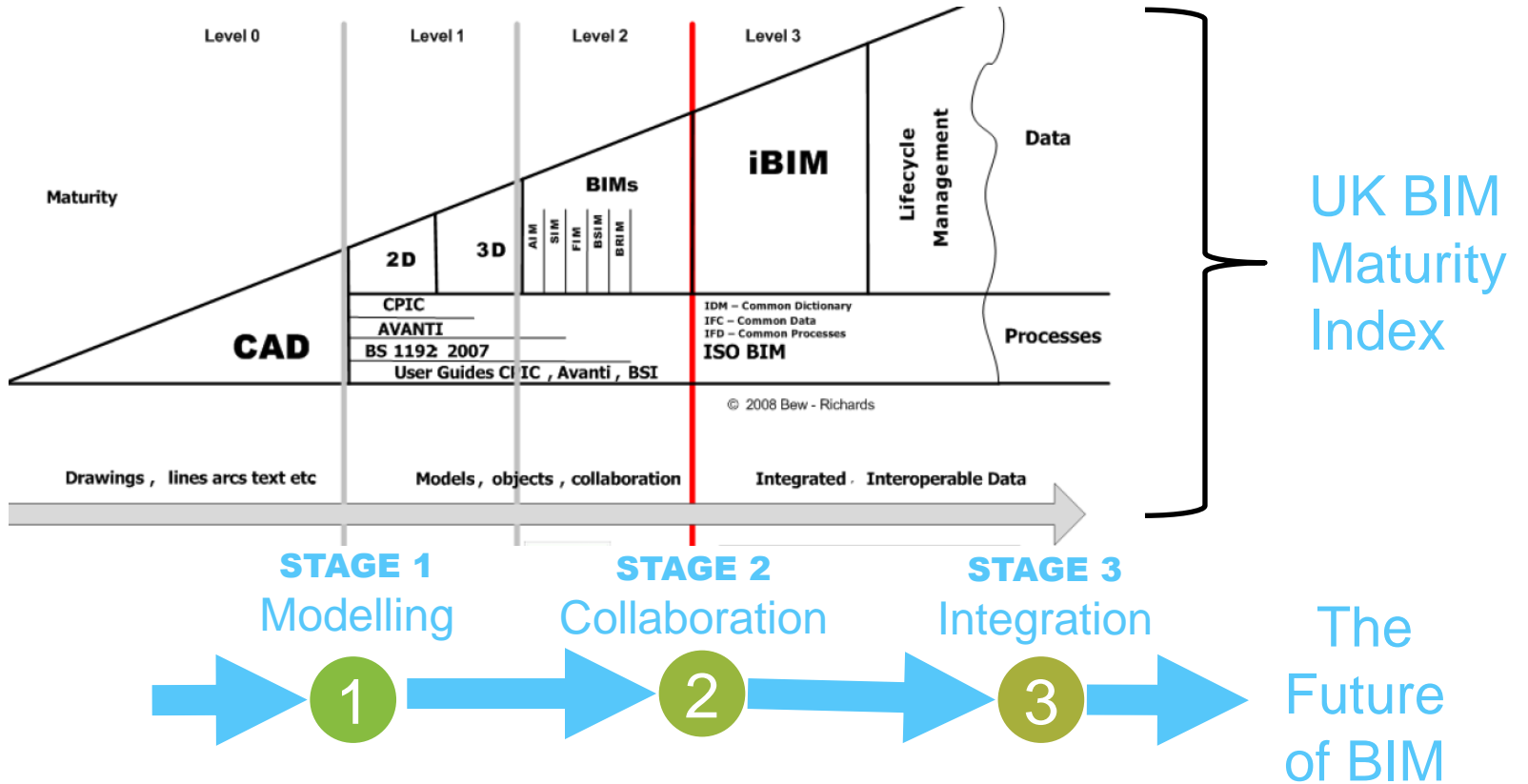

# BIM Transformation

It's an evolution

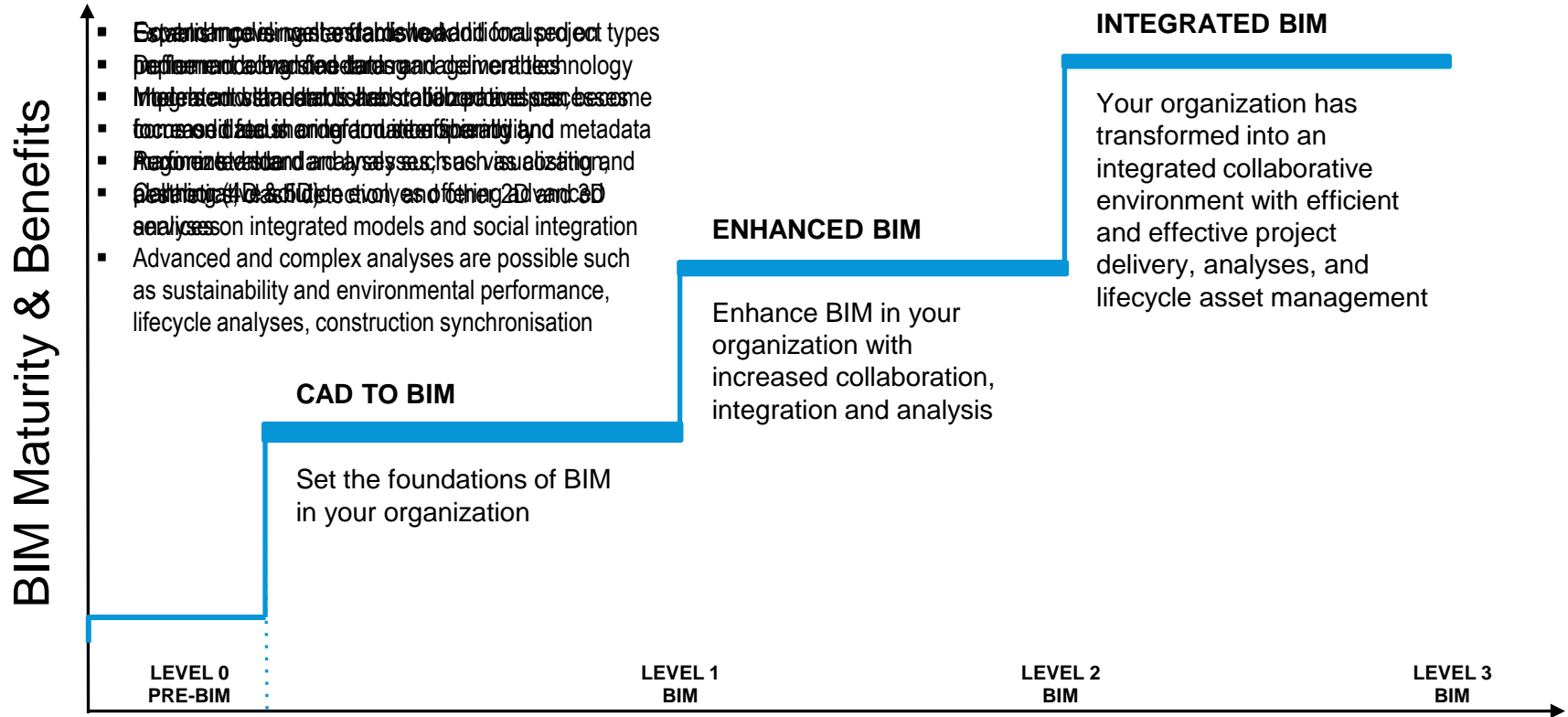



# Seek to Understand

- What is BIM ?
  - The Enterprise
  - The Project
  - The Individual
- What is expected from BIM ?
  - Benefits
  - Challenges
  - ROI

# BIM Implementation Framework | How We Do It

## SET FOUNDATION

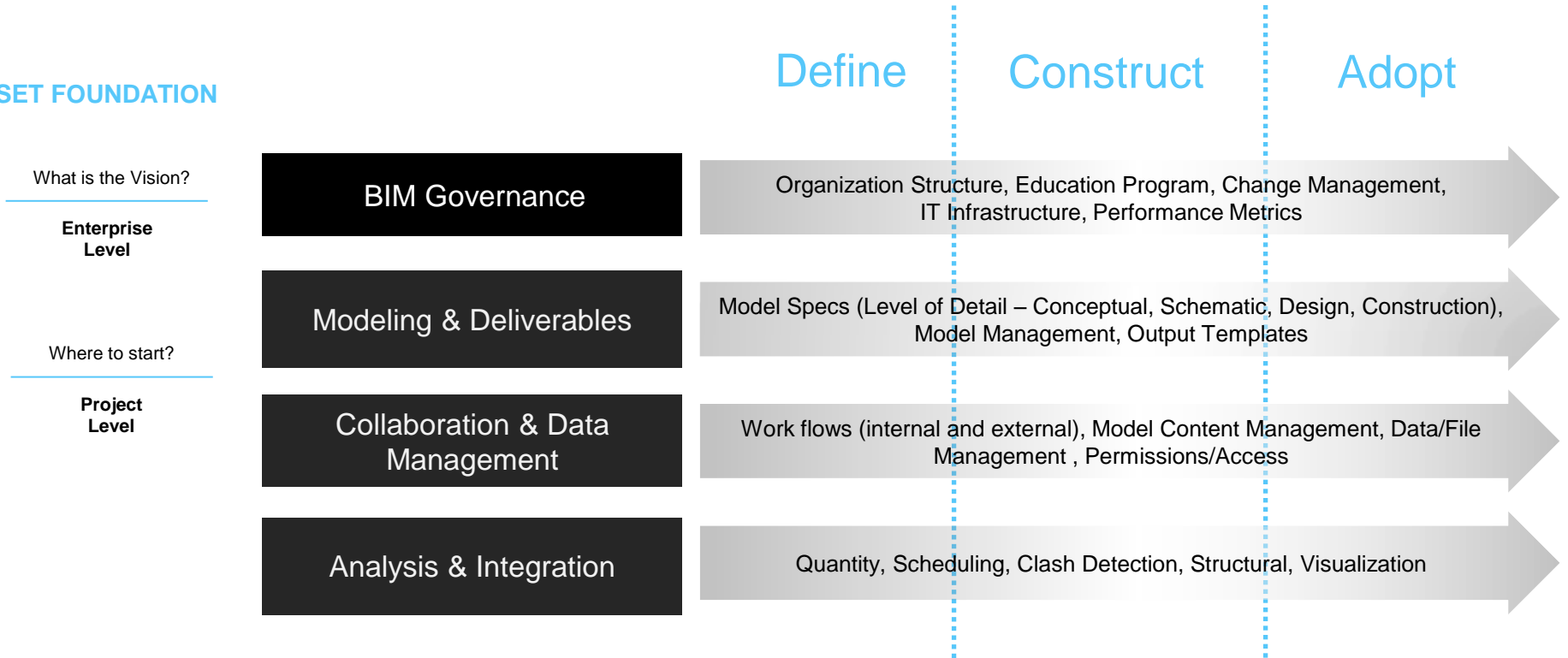

The background features a complex, abstract design of overlapping, flowing lines in shades of light blue, teal, and white. These lines create a sense of movement and depth, resembling a stylized, futuristic architectural or organic structure. The overall aesthetic is clean and modern.

# Dealing with Change

# Dealing with Changes

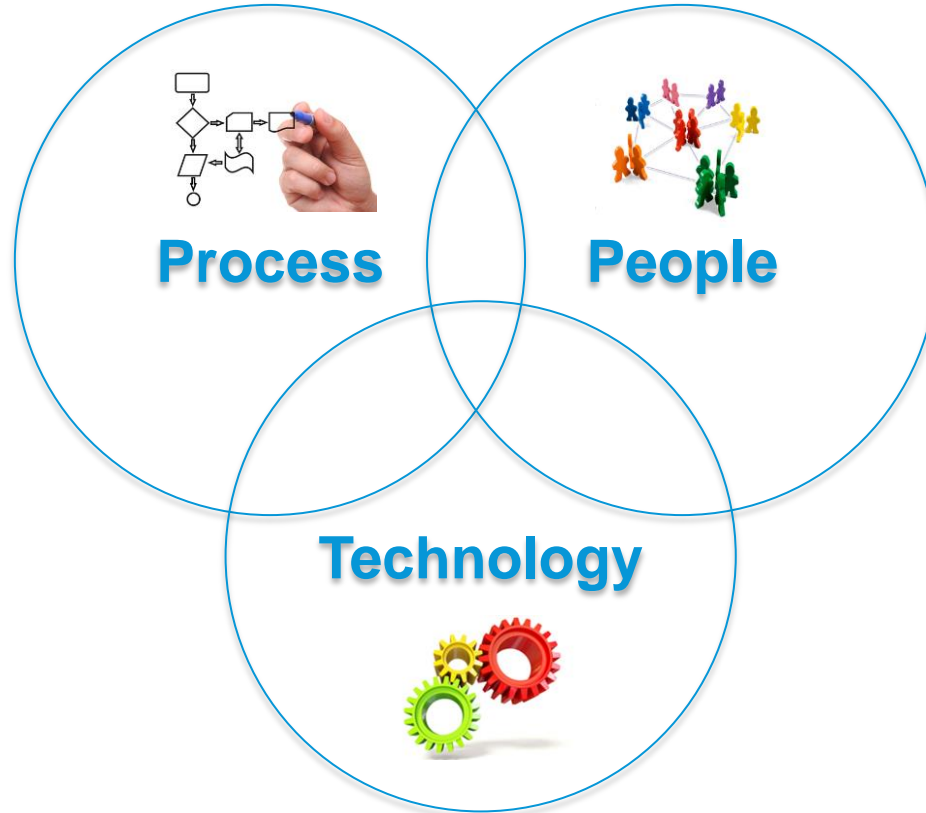



# Dealing with Changes

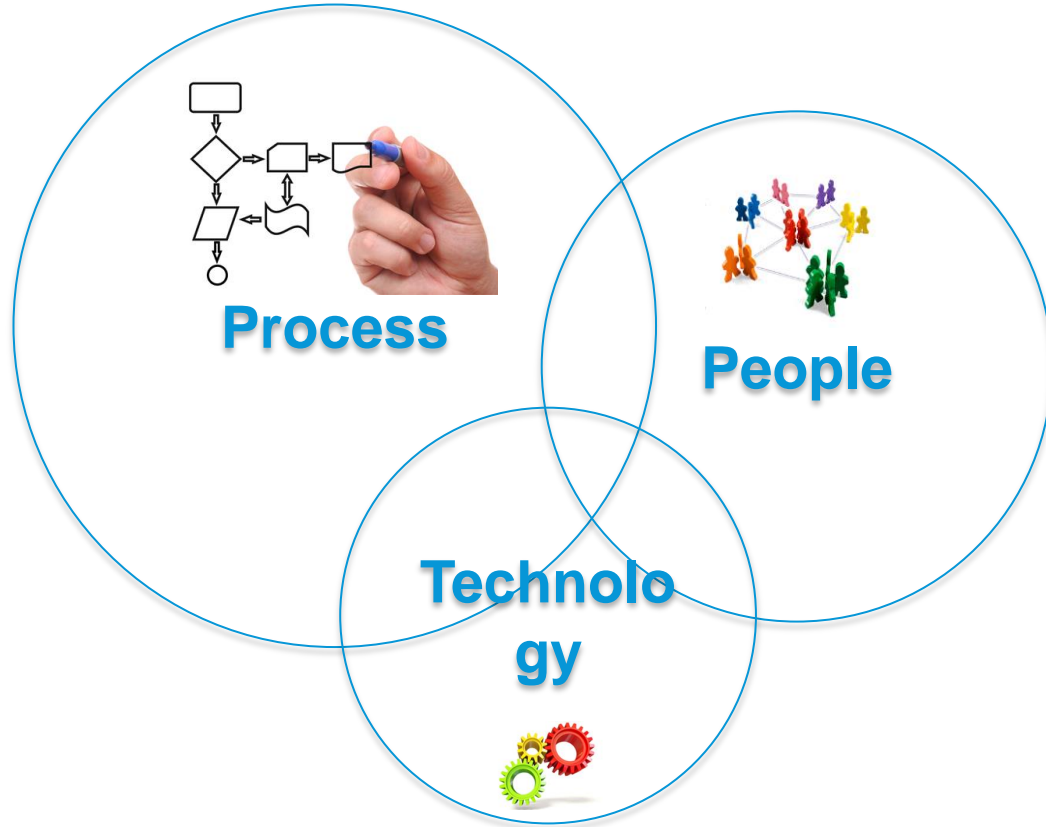

The background features a complex, abstract design of overlapping, flowing lines in shades of light blue, teal, and white. These lines create a sense of movement and depth, resembling a stylized architectural or organic structure. The overall aesthetic is clean and modern.

**So what can Autodesk Offer ?**

# BIM Service Offerings

## **BIM Policy and Strategy**

- BIM Maturity Assessment
- BIM ROI Workshop
- BIM Unique Business Value Definition and Monitoring
- BIM Implementation Plan Workshop

## **BIM Standards and Processes**

- BIM for Project Managers
- BIM Workflow Analysis (As-Is and To-Be)
- Enterprise/Project BIM Execution Plan
- Model Development Specification
- Data Management Strategy
- Content Management Strategy

## **BIM Change Management**

- Content Management Specification and Development
- Autodesk Product Configuration and Customization
- Education Needs Assessment, Curriculum Development and Training
- Project Health Checks, Model Reviews and Mentoring Support

## **Integrated BIM Solutions**

- API Tools Strategy, Specification and Development



Autodesk is a registered trademark of Autodesk, Inc., and/or its subsidiaries and/or affiliates in the USA and/or other countries. All other brand names, product names, or trademarks belong to their respective holders. Autodesk reserves the right to alter product and services offerings, and specifications and pricing at any time without notice, and is not responsible for typographical or graphical errors that may appear in this document.

© 2015 Autodesk. All rights reserved.